

12 BLOCK E 1ST FLOOR  
GAMES LOUNGE SOFA W/ DISPLAY SHELF  
SCALE 1:15

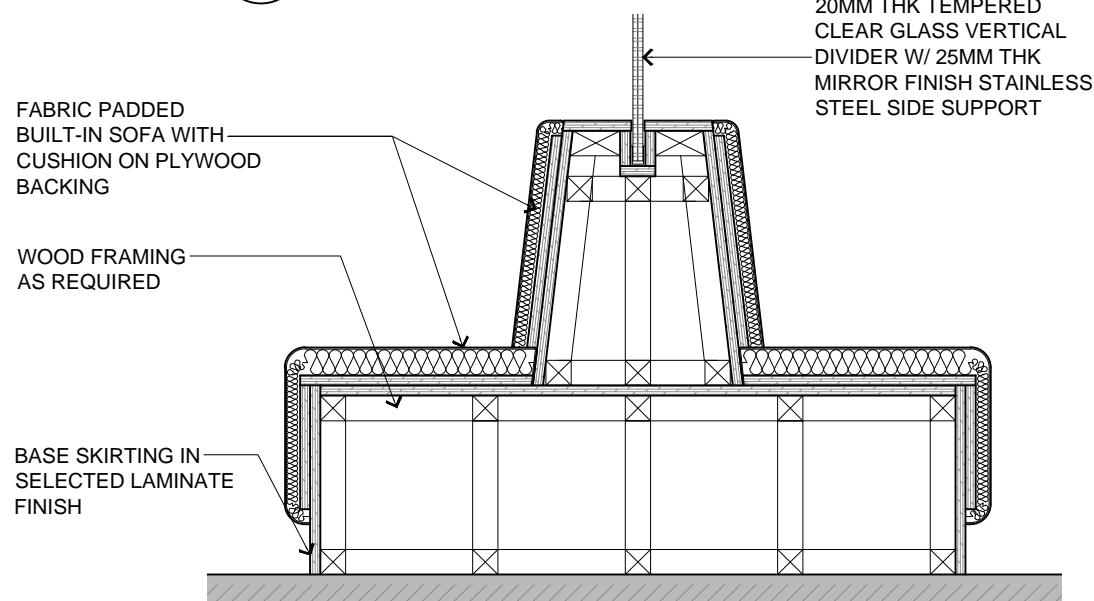

14 BLOCK E 1ST FLOOR  
GAMES LOUNGE SOFA W/ DISPLAY SHELF  
SCALE 1:15

FABRIC PADDED  
BUILT-IN SOFA WITH  
CUSHION ON PLYWOOD  
BACKING

20MM THK TEMPERED  
CLEAR GLASS VERTICAL  
DIVIDER W/ 25MM THK  
MIRROR FINISH STAINLESS  
STEEL SIDE SUPPORT

LINE OF 12MM THK TEMPERED  
CLEAR GLASS SHELVINGS

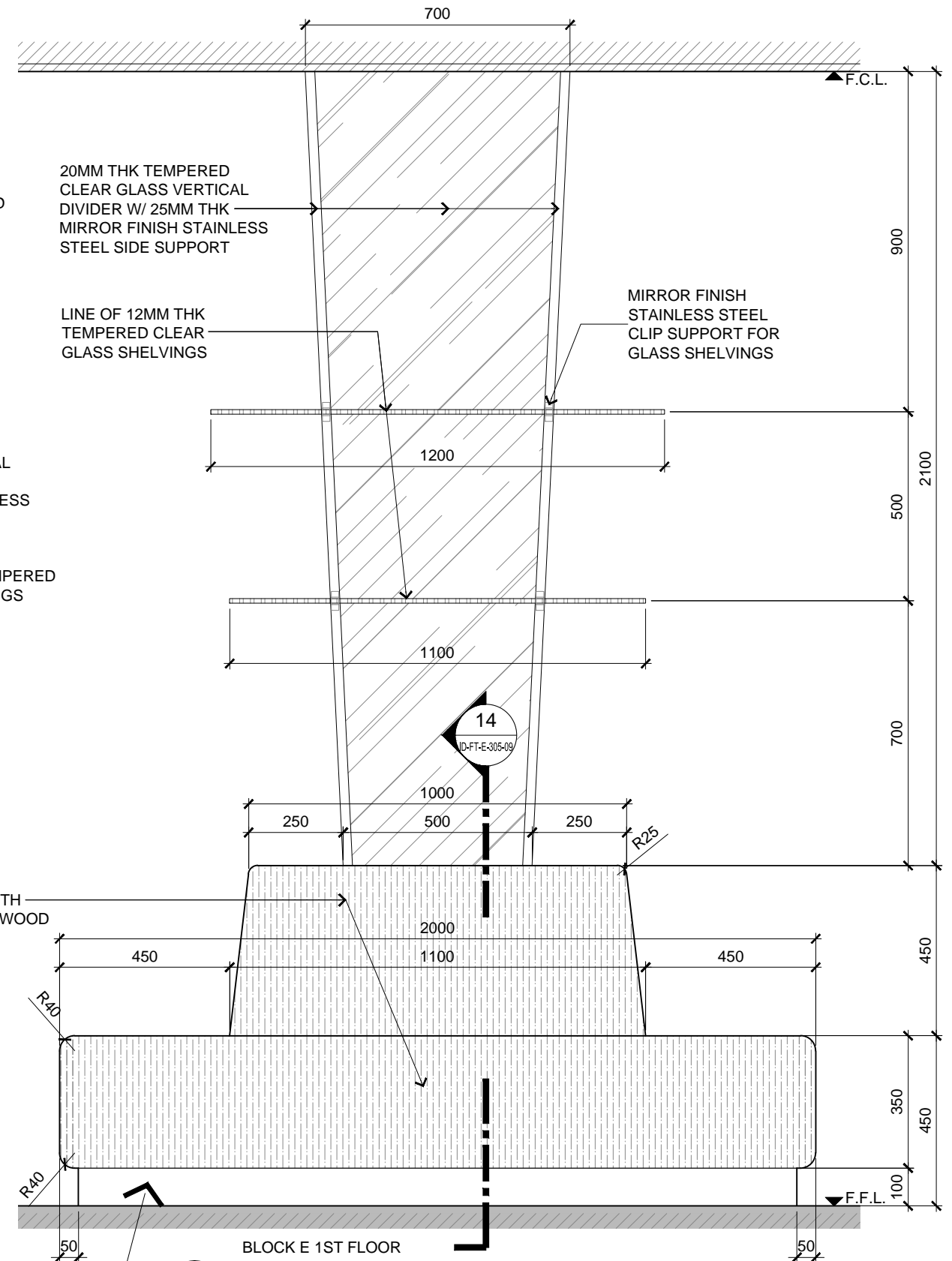

FABRIC PADDED  
BUILT-IN SOFA WITH  
CUSHION ON PLYWOOD  
BACKING

BASE SKIRTING IN  
SELECTED LAMINATE  
FINISH

13 BLOCK E 1ST FLOOR  
GAMES LOUNGE SOFA W/ DISPLAY SHELF  
SCALE 1:15

## TENDER DRAWING



ARCHITECTURE GROUP-STUDIO A  
CPG CONSULTANTS PTE LTD  
1 GATEWAY DRIVE #25-01  
WESTGATE TOWER, SINGAPORE 608531  
TEL: 6357 4888 FAX: 6357 4188

©2014, CPG Consultants Pte Ltd reserves all rights to these drawings, designs and/or any other data contained herein. No part of the said drawings, designs and/or other data may be reproduced, modified, transmitted or used in any form or by any means for any purpose without the prior written consent of CPG Consultants Pte Ltd other than the sole purpose for which such drawings, designs and/or other data are provided to licensed users on such terms as CPG Consultants Pte Ltd may prescribe.

Job Title  
INTERIOR DESIGN WORKS FOR PROPOSED KDU PENANG  
@ BATU KAWAN, PENANG MALAYSIA

Drawing Title  
GAMES LOUNGE ELEVATIONS  
BLOCK E 1ST FLOOR

Senior Vice President	TAN PHENG CHEE
Vice President	PATRICK TAN
Principal Architectural Associate	-
Architectural Associate	-
Principal Interior Designer	BETH SONCUYA

Drawn By	TEAM	Date: JULY 16
Checked By	BETH	Date: JULY 16
Project Code :	P5679	Drawing No. : ID-FT-E-305-09
REV.	-	Scale : 1:15 CAD Ref.