

**2A** BLOCK A GROUND FLOOR - STUDENT SERVICE DEPT.  
TOP HUNG CABINET ELEVATION  
SCALE 1:30

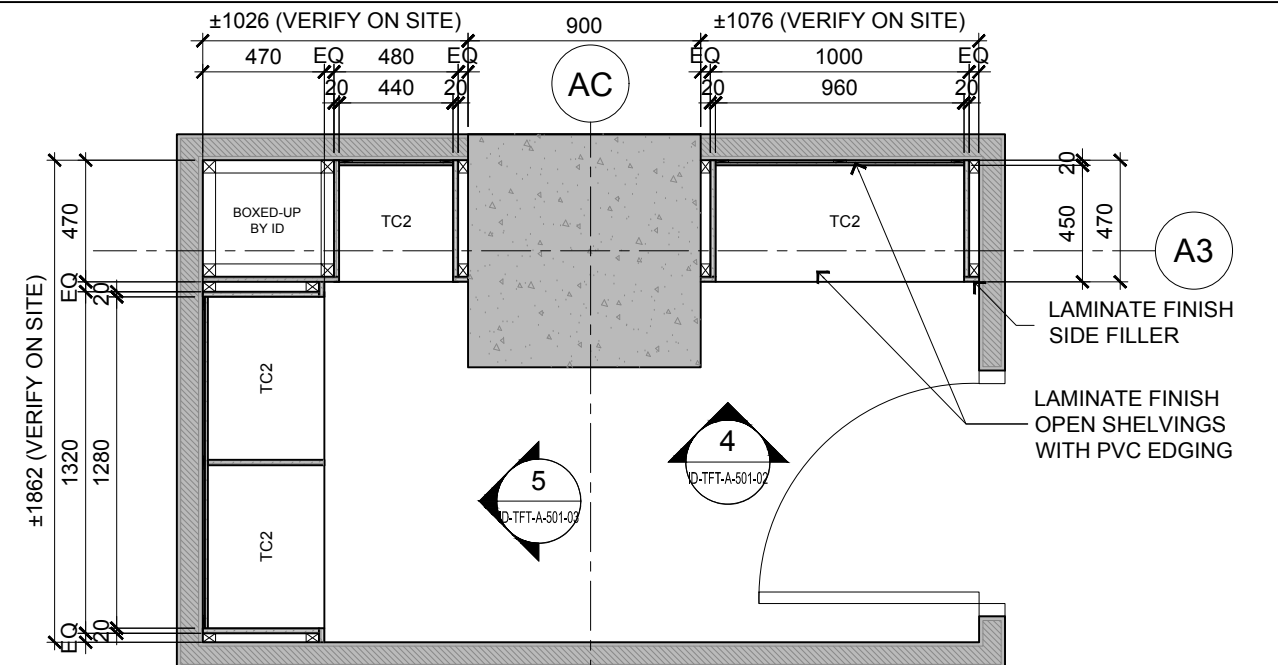

**3** BLOCK A GROUND FLOOR - STUDENT SERVICE DEPT.  
FULL HEIGHT OPEN SHELVING PLAN  
SCALE 1:30

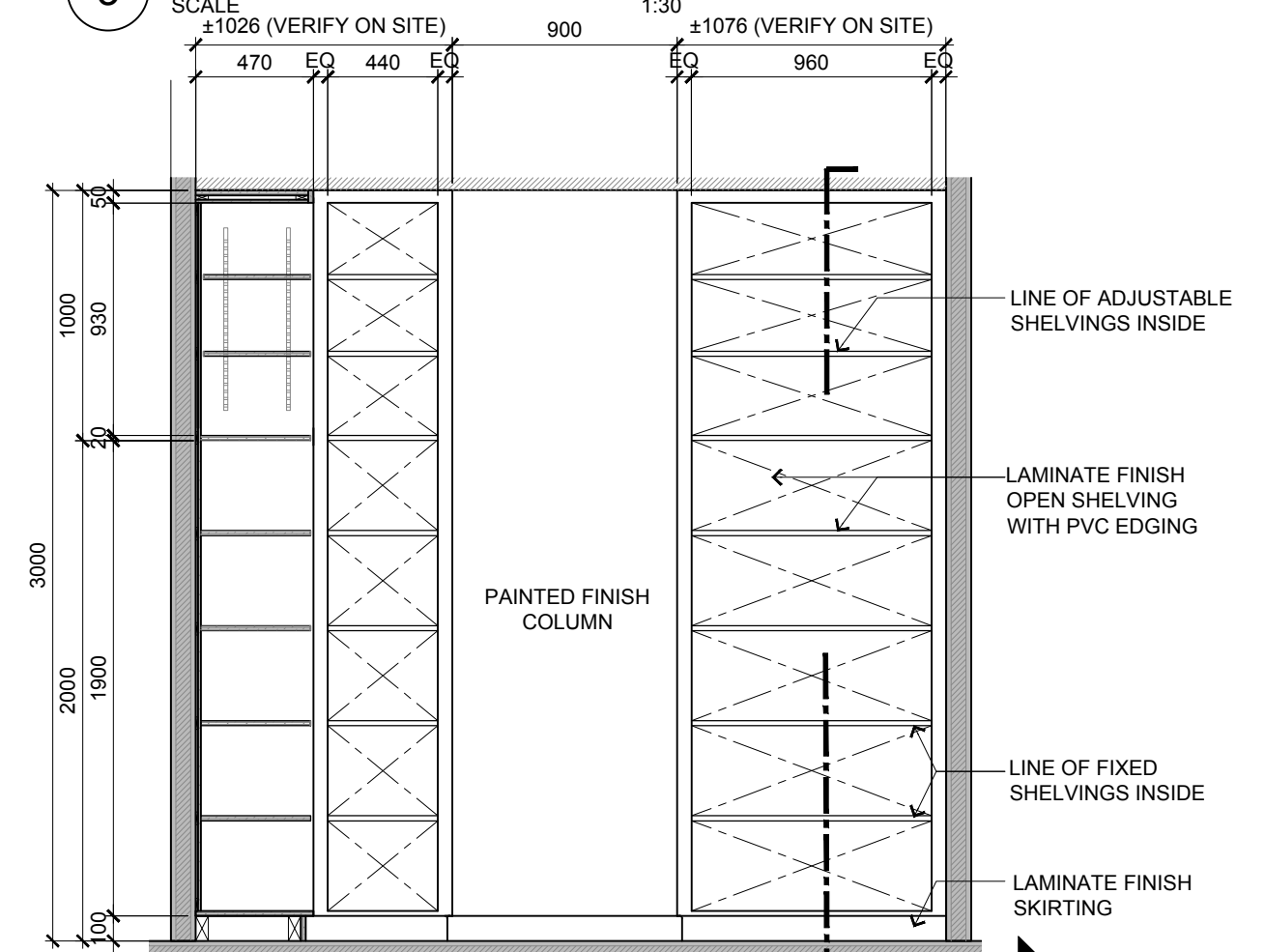

**4** BLOCK A GROUND FLOOR - STUDENT SERVICE DEPT.  
FULL HEIGHT OPEN SHELVING ELEVATION  
SCALE 1:30

**TENDER DRAWING**



ARCHITECTURE GROUP-STUDIO A  
**CPG CONSULTANTS PTE LTD**  
1 GATEWAY DRIVE #25-01  
WESTGATE TOWER, SINGAPORE 608531  
TEL: 6357 4888 FAX: 6357 4188

©2014, CPG Consultants Pte Ltd reserves all rights to these drawings, designs and/or any other data contained herein. No part of the said drawings, designs and/or other data may be reproduced, modified, transmitted or used in any form or by any means for any purpose without the prior written consent of CPG Consultants Pte Ltd other than the sole purpose for which such drawings, designs and/or other data are provided to licensed users on such terms as CPG Consultants Pte Ltd may prescribe.

Job Title  
PROPOSED KDU PENANG @ BATU KAWAN,  
PENANG MALAYSIA

Drawing Title  
**CABINET/ SHELVING DETAILS**  
BLOCK A GROUND FLOOR

|                                   |                |
|-----------------------------------|----------------|
| Senior Vice President             | TAN PHENG CHEE |
| Vice President                    | PATRICK TAN    |
| Principal Architectural Associate | -              |
| Architectural Associate           | -              |
| Principal Interior Designer       | BETH SONCUYA   |

|                |                 |               |
|----------------|-----------------|---------------|
| Drawn By       | TEAM            | Date: JULY 16 |
| Checked By     | BETH            | Date: JULY 16 |
| Project Code : | Drawing No. :   | REV.          |
| P5679          | ID-TFT-A-501-02 | -             |
| Scale : 1:30   |                 | CAD Ref.      |