

1 BLOCK A GROUND FLOOR - ACADEMIC PROGRAM LEADER
RECEPTION COUNTER PLAN
SCALE 1:25

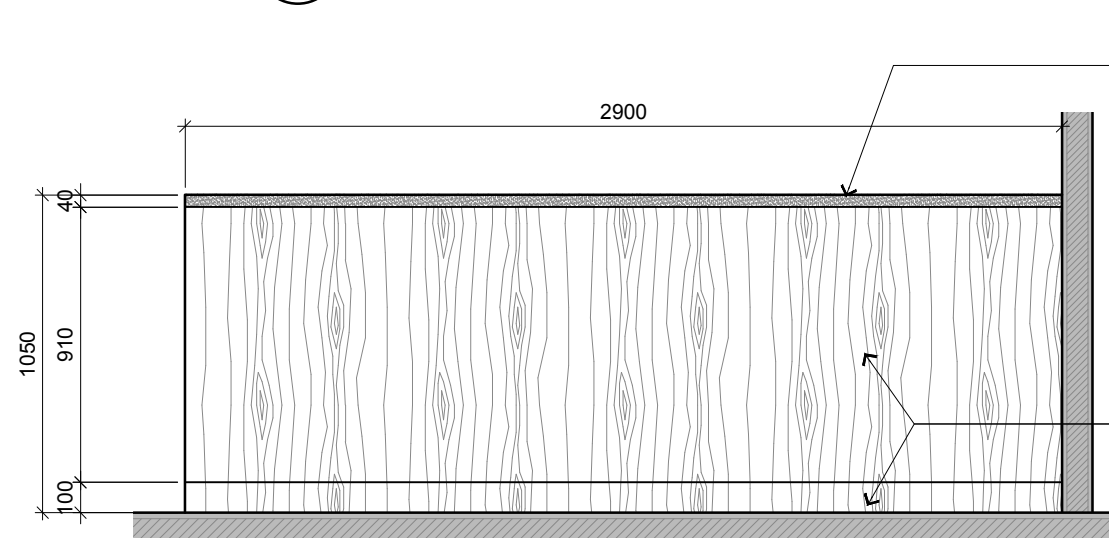

2 BLOCK A GROUND FLOOR - ACADEMIC PROGRAM LEADER
RECEPTION COUNTER ELEVATION
SCALE 1:25

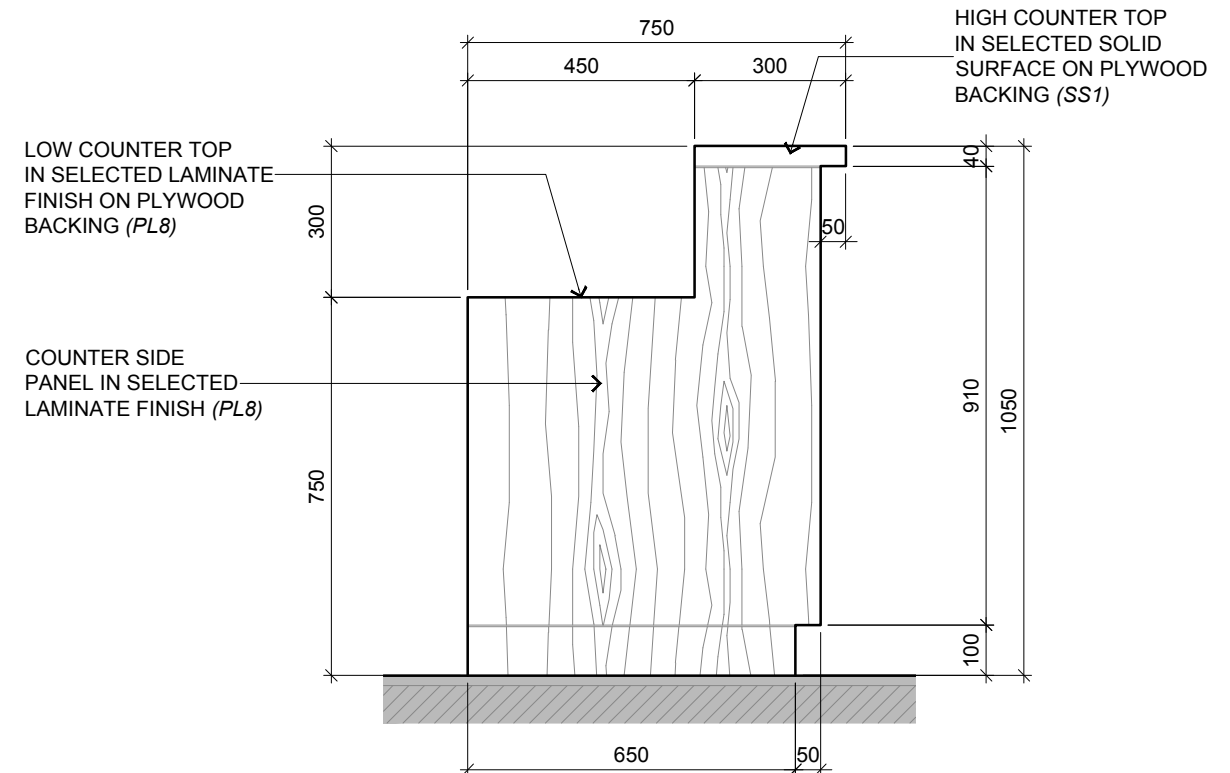

3 BLOCK A GROUND FLOOR - ACADEMIC PROGRAM LEADER
RECEPTION COUNTER ELEVATION
SCALE 1:15

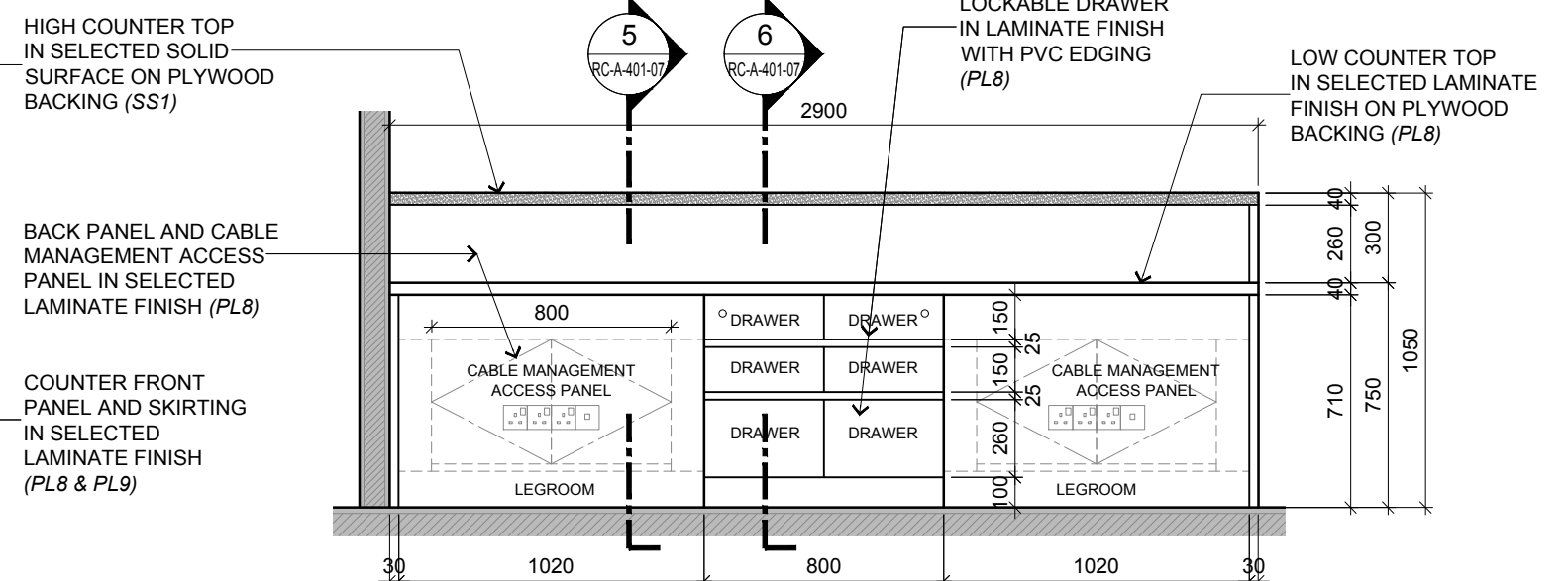

4 BLOCK A GROUND FLOOR - ACADEMIC PROGRAM LEADER
RECEPTION COUNTER ELEVATION
SCALE 1:25

RC-03



ARCHITECTURE GROUP-STUDIO A
CPG CONSULTANTS PTE LTD
1 GATEWAY DRIVE #25-01
WESTGATE TOWER, SINGAPORE 608531
TEL: 6357 4888 FAX: 6357 4188

©2014, CPG Consultants Pte Ltd reserves all rights to these drawings, designs and/or any other data contained herein. No part of the said drawings, designs and/or other data may be reproduced, modified, transmitted or used in any form or by any means for any purpose without the prior written consent of CPG Consultants Pte Ltd other than the sole purpose for which such drawings, designs and/or other data are provided to licensed users on such terms as CPG Consultants Pte Ltd may prescribe.

Job Title
INTERIOR DESIGN WORKS FOR PROPOSED KDU PENANG
@ BATU KAWAN, PENANG MALAYSIA

Drawing Title
RC-03 RECEPTION COUNTER DETAILS
BLOCK A 1ST FLOOR - ACADEMIC PROGRAM LEADER

Senior Vice President	TAN PHENG CHEE
Vice President	PATRICK TAN
Principal Interior Designer	BETH SONCUYA
Principal Architectural Associate	-
Architectural Associate	-

TENDER DRAWING			
Drawn By	TEAM	Date:	30 MAR 2017
Checked By	BETH	Date:	30 MAR 2017
Project Code :	P5679	Drawing No. :	ID-RC-A-401-06
REV.	-	Scale :	AS SHOWN
		CAD Ref.	