

PROGRESS CLAIM OF STAGE COMPLETION

TO : BH YEW ARCHITECT C.C. : P. KELANA Ref.No.: PPPW/PM/BHY/UKB1A/001/17
 PROJECT : UTROPOLIS BATU KAWAN
 PHASE : 1A UNITS NO.: 12B, 15, 16, 17, 18, 19, 20, 21
 TYPE OF UNITS: OFFICE & RETAIL SHOPS 38, 39, 40, 41, 42, 43, 43A
 TOWER :
 LEVEL : LEVEL 1

COMPLETION OF CONSTRUCTION WORKS FOR CERTIFICATION OF STAGE OF COMPLETION

This is to inform that the construction of the above unit/units have been completed up to the following stages:

| | | |
|---|------|-------------------------------------|
| 2a) The piling works of the building comprising of the Parcel | 15% | <input checked="" type="checkbox"/> |
| 2b) The pile-caps of the building comprising of the Parcel | 15% | <input type="checkbox"/> |
| 2c) The ground beam of the building comprising of the Parcel | 15% | <input type="checkbox"/> |
| 2d) The reinforced concrete framework of the Parcel | 15% | <input type="checkbox"/> |
| 2e) The brickwalls of the Parcel | 5% | <input type="checkbox"/> |
| 2f) The internal electrical wiring and the telephone trunking (without fittings) of the Parcel | 5% | <input type="checkbox"/> |
| 2g) The internal plastering of the Parcel | 5% | <input type="checkbox"/> |
| 2h) The external plastering of the Parcel | 5% | <input type="checkbox"/> |
| 2i) The external roads serving the building comprising of the Parcel | 2.5% | <input type="checkbox"/> |
| 2j) The drainage serving the building comprising of the Parcel | 2.5% | <input type="checkbox"/> |
| 2k) The sewerage works serving the building comprising of the Parcel | 2.5% | <input type="checkbox"/> |
| 3. Upon completion of the above construction works of the Parcel as certified by the Vendor's Architect | 2.5% | <input type="checkbox"/> |

VERIFIED BY

NAME

SIGNATURE

SITE REPRESENTATIVE

SUN YONG LIM 12/1

PROJECT MANAGER

WONG KEAT CHIN 12/1

* STRUCTURAL ENGINEER

Lau Wai Kwan 12/1

CIVIL ENGINEER

M & E ENGINEER

Progress claims faxed/delivered to Architect/Engineer

Certification received from Architect/Engineer

Date & Time : 14/1/2017

Date & Time :

Signature :

Signature :

Name :

WONG KEAT CHIN

Name :

**PARAMOUNT
PROPERTY**

Paramount Property (PW) Sdn Bhd 1057143-D
 A SUBSIDIARY OF PARAMOUNT CORPORATION BERHAD
 No. 55, Jalan Icon City, Icon City, 14000 Bukit Mertajam, Pulau Pinang
 T +60(4) 506 0350 F +60(4) 506 0351 W www.paramountproperty.my

PROGRESS CLAIM OF STAGE COMPLETION

TO : BH YEW ARCHITECT C.C. : P. KELANA Ref.No.: PPPW/PM/BHY/UKB1A/002/17
PROJECT : UTROPOLIS BATU KAWAN
PHASE : 1A UNITS NO.: 16, 17, 18, 19, 20, 21, 22, 23, 23A,
TYPE OF UNITS: OFFICE & RETAIL SHOPS 25, 51, 52, 53, 53A, 55, 56, 57, 58
TOWER : 59, 60
LEVEL : LEVEL 2

COMPLETION OF CONSTRUCTION WORKS FOR CERTIFICATION OF STAGE OF COMPLETION

This is to inform that the construction of the above unit/units have been completed up to the following stages:

- | | | |
|---|------|-------------------------------------|
| 2a) The piling works of the building comprising of the Parcel | 15% | <input checked="" type="checkbox"/> |
| 2b) The pile-caps of the building comprising of the Parcel | 15% | <input type="checkbox"/> |
| 2c) The ground beam of the building comprising of the Parcel | 15% | <input type="checkbox"/> |
| 2d) The reinforced concrete framework of the Parcel | 15% | <input type="checkbox"/> |
| 2e) The brickwalls of the Parcel | 5% | <input type="checkbox"/> |
| 2f) The internal electrical wiring and the telephone trunking (without fittings) of the Parcel | 5% | <input type="checkbox"/> |
| 2g) The internal plastering of the Parcel | 5% | <input type="checkbox"/> |
| 2h) The external plastering of the Parcel | 5% | <input type="checkbox"/> |
| 2i) The external roads serving the building comprising of the Parcel | 2.5% | <input type="checkbox"/> |
| 2j) The drainage serving the building comprising of the Parcel | 2.5% | <input type="checkbox"/> |
| 2k) The sewerage works serving the building comprising of the Parcel | 2.5% | <input type="checkbox"/> |
| 3. Upon completion of the above construction works of the Parcel as certified by the Vendor's Architect | 2.5% | <input type="checkbox"/> |

VERIFIED BY

NAME

SIGNATURE

SITE REPRESENTATIVE

SIN YONG LIM 12/1

PROJECT MANAGER

WONG KEAT CHIN 12/1

* STRUCTURAL ENGINEER

Lau Wai Kwan 12/1

CIVIL ENGINEER

M & E ENGINEER

Progress claims faxed/delivered to Architect/Engineer

Certification received from Architect/Engineer

Date & Time : 19/1/2017

Date & Time :

Signature :

Signature :

Name :

WONG KEAT CHIN

Name :

**PARAMOUNT
PROPERTY**

Paramount Property (PW) Sdn Bhd 1057143-D
A SUBSIDIARY OF PARAMOUNT CORPORATION BERHAD
No. 55, Jalan Icon City, Icon City, 14000 Bukit Mertajam, Pulau Pinang
T +60(4) 506 0350 F +60(4) 506 0351 W www.paramountproperty.my

PROGRESS CLAIM OF STAGE COMPLETION

TO : BH YEW ARCHITECT C.C. : P. KELANA Ref.No.: PPPW/PM/BHY/UKB1A/003/17

PROJECT : UTROPOLIS BATU KAWAN

PHASE : 1A UNITS NO.: 16, 17, 18, 19, 20, 21, 22, 23, 23A,

TYPE OF UNITS: OFFICE & RETAIL SHOPS 25, 50, 51, 52, 53, 53A, 55, 56, 57,



TOWER : 58, 59

LEVEL : LEVEL 3

COMPLETION OF CONSTRUCTION WORKS FOR CERTIFICATION OF STAGE OF COMPLETION

This is to inform that the construction of the above unit/units have been completed up to the following stages:

- | | | |
|---|------|-------------------------------------|
| 2a) The piling works of the building comprising of the Parcel | 15% | <input checked="" type="checkbox"/> |
| 2b) The pile-caps of the building comprising of the Parcel | 15% | <input type="checkbox"/> |
| 2c) The ground beam of the building comprising of the Parcel | 15% | <input type="checkbox"/> |
| 2d) The reinforced concrete framework of the Parcel | 15% | <input type="checkbox"/> |
| 2e) The brickwalls of the Parcel | 5% | <input type="checkbox"/> |
| 2f) The internal electrical wiring and the telephone trunking (without fittings) of the Parcel | 5% | <input type="checkbox"/> |
| 2g) The internal plastering of the Parcel | 5% | <input type="checkbox"/> |
| 2h) The external plastering of the Parcel | 5% | <input type="checkbox"/> |
| 2i) The external roads serving the building comprising of the Parcel | 2.5% | <input type="checkbox"/> |
| 2j) The drainage serving the building comprising of the Parcel | 2.5% | <input type="checkbox"/> |
| 2k) The sewerage works serving the building comprising of the Parcel | 2.5% | <input type="checkbox"/> |
| 3. Upon completion of the above construction works of the Parcel as certified by the Vendor's Architect | 2.5% | <input type="checkbox"/> |

| <u>VERIFIED BY</u> | <u>NAME</u> | <u>SIGNATURE</u> |
|-----------------------|---------------------|---|
| SITE REPRESENTATIVE | SIN YONG LIM 12/1 |  |
| PROJECT MANAGER | WONG KEAT CHIN 12/1 |  |
| X STRUCTURAL ENGINEER | Lau Wai Kwan 11/1 |  |
| CIVIL ENGINEER | | |
| M & E ENGINEER | | |

Progress claims faxed/delivered to Architect/Engineer

Certification received from Architect/Engineer

Date & Time : 19/1/2017

Signature : 

Name : WONG KEAT CHIN

Date & Time :

Signature :

Name :

PARAMOUNT
PROPERTY

Paramount Property (PW) Sdn Bhd 1057143-D
A SUBSIDIARY OF PARAMOUNT CORPORATION BERHAD
No. 55, Jalan Icon City, Icon City, 14000 Bukit Mertajam, Pulau Pinang
T +60(4) 506 0350 F +60(4) 506 0351 W www.paramountproperty.my



LEVEL 1 53 Units

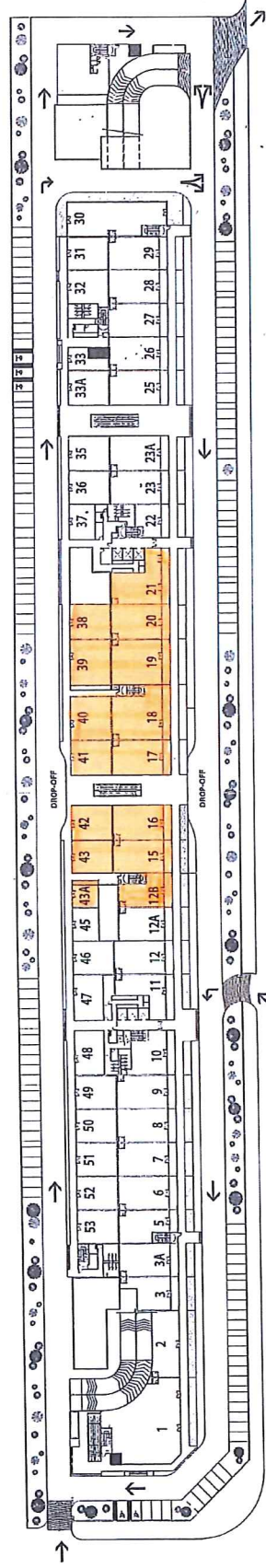

LEVEL 2 72 Units

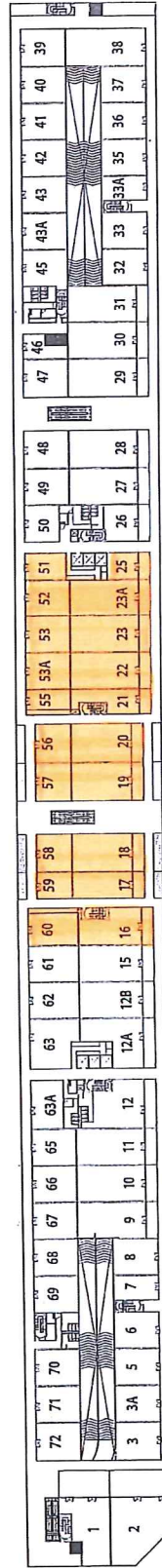

LEVEL 3 71 Units

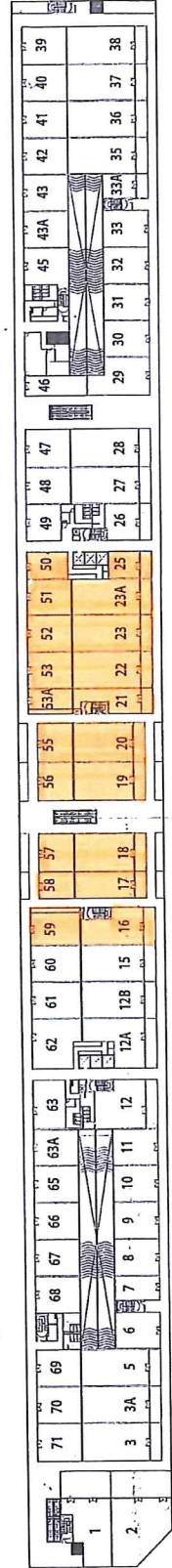

REF: PDPH/PA/MSH/UCB1.0/
004-003/17

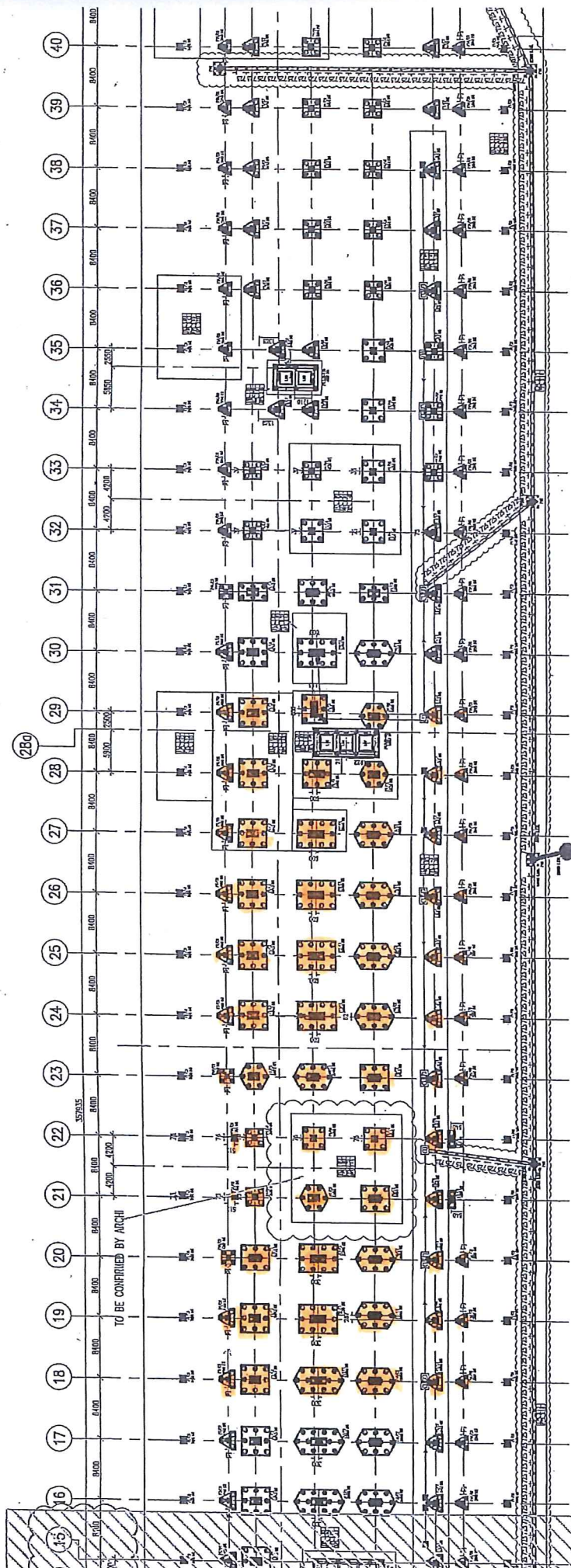



13/01/2017

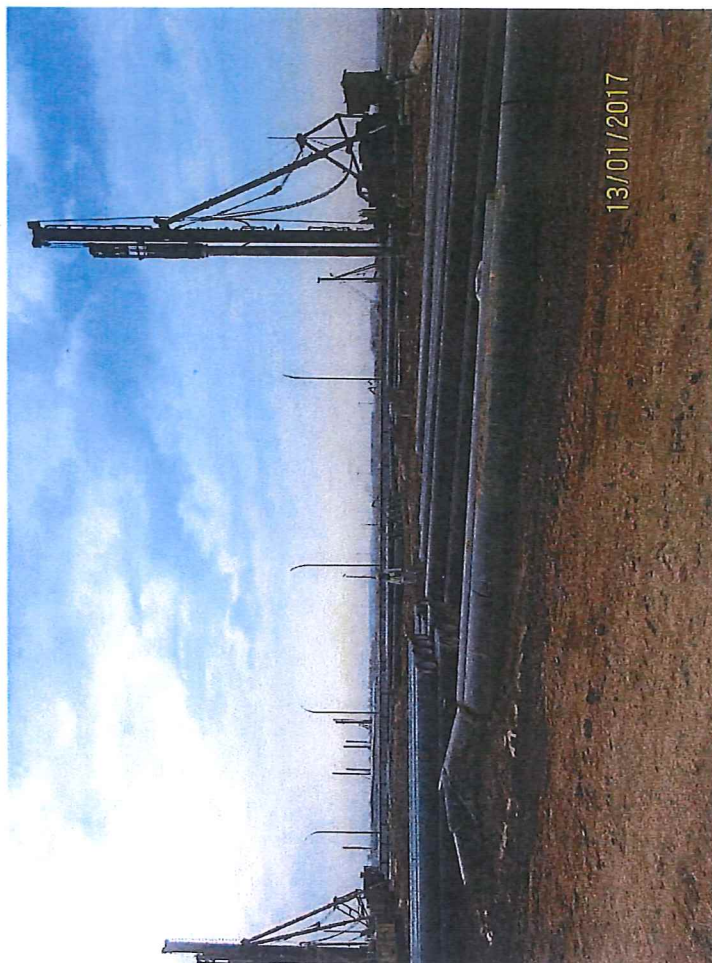

13/01/2017



13/01/2017



13/01/2017