

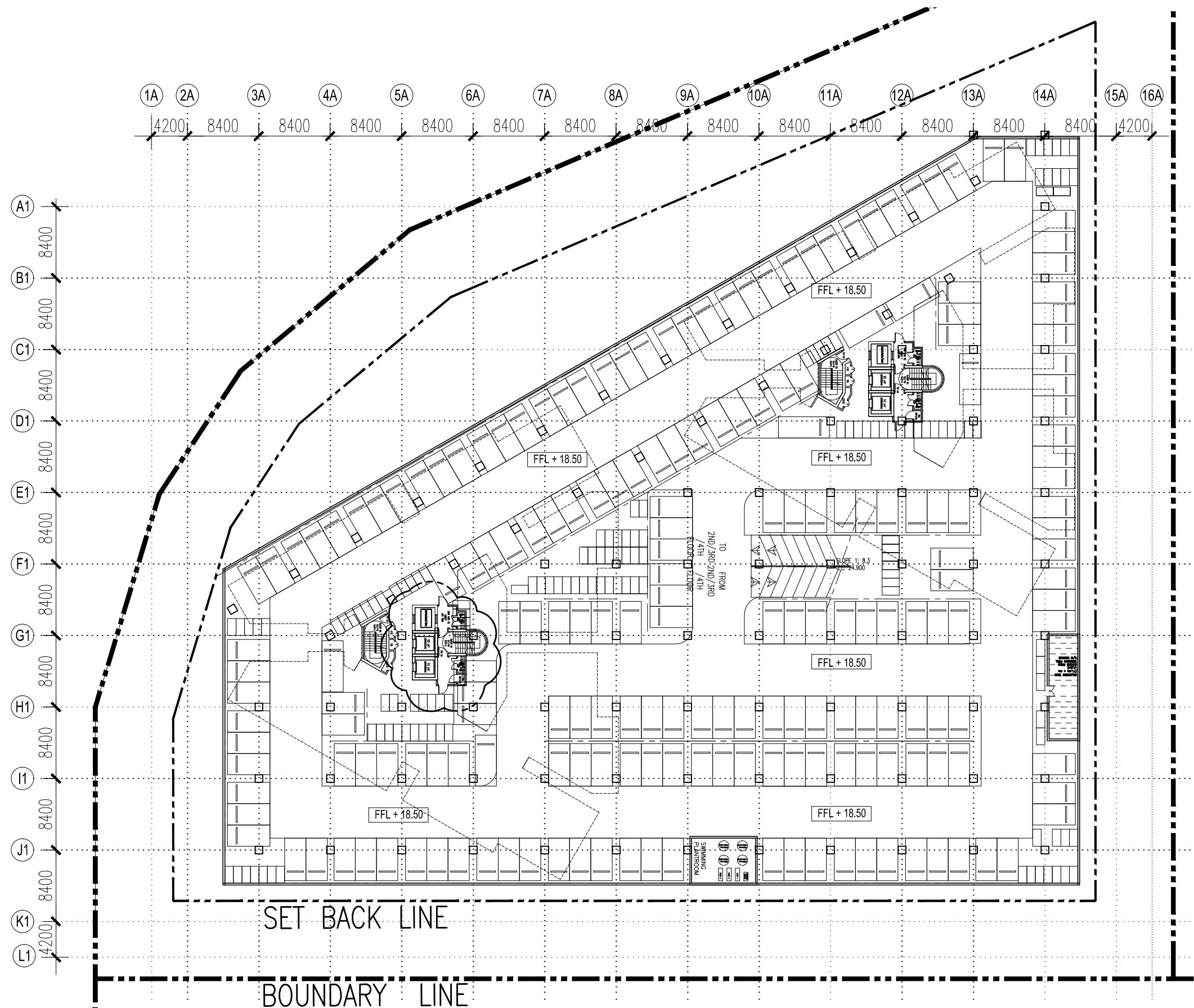

CAR PARK - L5 FLOOR PLAN

scale 1:500

CAR PARK LOTS : 201 NOS.*
MOTORCYCLE LOTS : 140 NOS.*
*SUBJECT TO STRUCTURAL COORDINATION



CPG CONSULTANTS PTE LTD

238B, THOMSON ROAD, #12-00 TOWNER B
NOVENA SQUARE, SINGAPORE 307685
TEL : 63574401 FAX : 63574398

© 2002, CPG CONSULTANTS PTE LTD
CPG CONSULTANTS PTE LTD RESERVES ALL RIGHTS TO THESE
DRAWINGS, DESIGNS AND/OR ANY OTHER DATA CONTAINED
HEREIN. NO PART OF THE DRAWINGS, DESIGNS AND/OR OTHER
DATA MAY BE REPRODUCED, MODIFIED, TRANSMITTED OR USED IN
ANY FORM OR BY ANY MEANS FOR ANY PURPOSE WITHOUT THE
PRIOR WRITTEN CONSENT OF CPG CONSULTANTS PTE LTD. OTHER
THAN THE SOLE PURPOSE FOR WHICH SUCH DRAWINGS, DESIGNS
AND/OR OTHER DATA ARE PROVIDED TO LICENCED USERS ON
SUCH TERMS AS CPG CONSULTANTS PTE LTD MAY PRESCRIBE.

NOTE:
ALL DETAILS SHOWN IN DRAWING ARE INDICATIVE OF ARCHITECT'S
DESIGN INTENT ONLY. CONTRACTOR IS TO CHECK/VERIFY ALL
DIMENSIONS ON SITE & TO SUBMIT SHOP DRAWINGS & FIXING
DETAILS FOR S.O.'S REVIEW & APPROVAL BEFORE COMMENCEMENT
OF ANY FABRICATION WORKS.

SENIOR VICE PRESIDENT
(ARCHITECTURE)

ARCHITECTURE ASSOCIATE
(ARCHITECTURE)

PROJECT NO. : P5541

CADD NO. :

VAH AIR CWX

DRAWN BY :

CHECKED BY :

AIR

CWX

CYK

JOB TITLE :

PARAMOUNT COMMERCIAL
MIXED USE DEVELOPMENT
@ BATU KAWAN, PENANG, MALAYSIA

SCALE :

DATE :

1:500

19/10/2015

REVISION INDEX :

DRAWING TITLE :

PLOT 2 - L5 FLOOR PLAN

DRAWING NO. :

A253