

DOUBLE
CHAMBER
SUBSTATION

SINGLE
CHAMBER
SUBSTATION

11kV TNB
SSU

G,1,2

TOTAL: 1977 cp

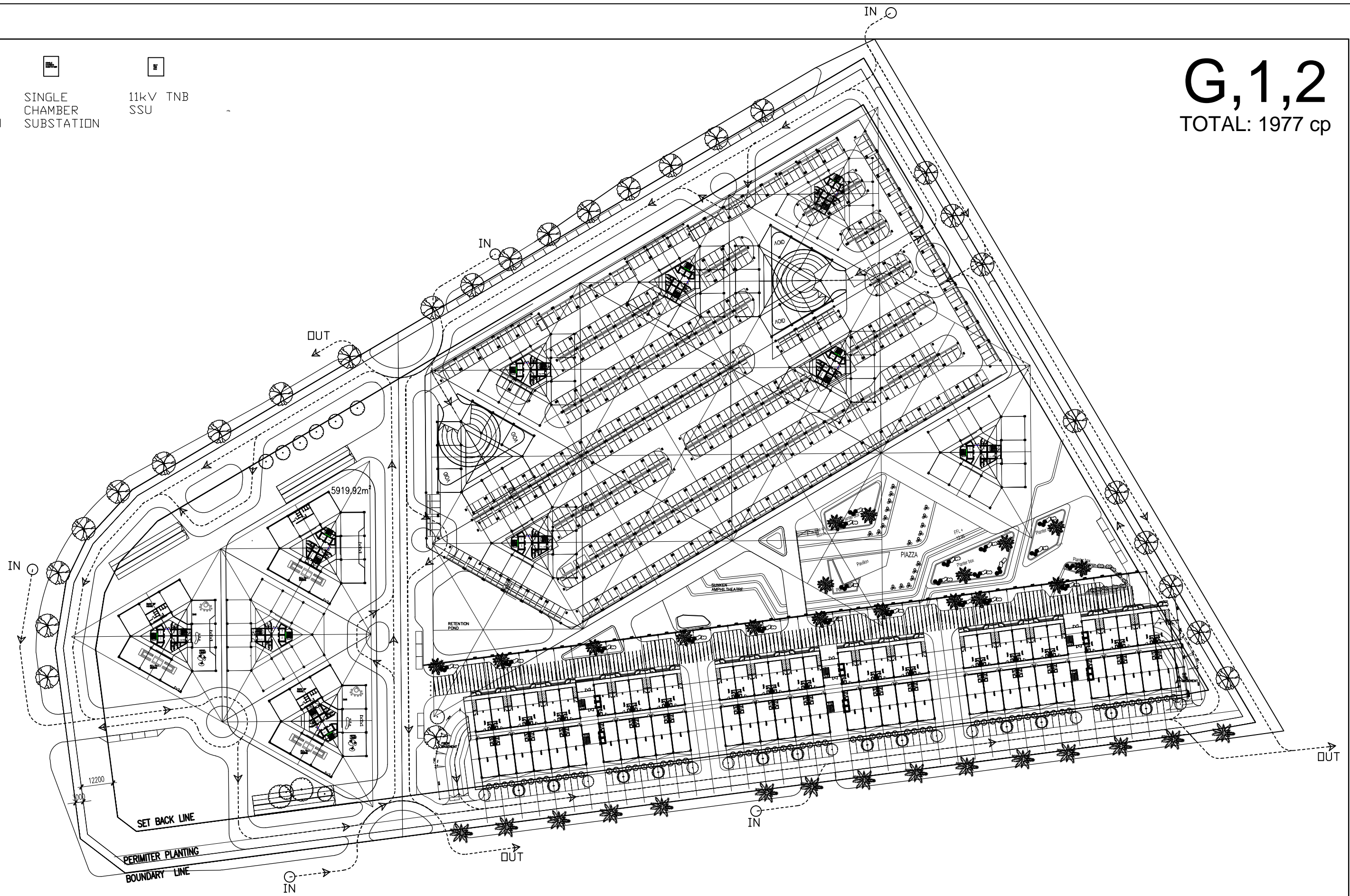

CPG CONSULTANTS PTE LTD
238B, THOMSON ROAD, #12-00 TOWNER B
NOVENA SQUARE, SINGAPORE 307685
TEL : 63574401 FAX : 63574398

" © 2002, CPG CONSULTANTS PTE LTD
CPG CONSULTANTS PTE LTD RESERVES ALL RIGHTS TO THESE
DRAWINGS, DESIGNS AND/OR ANY OTHER DATA CONTAINED
HEREIN. NO PART OF THE DRAWINGS, DESIGNS AND/OR OTHER
DATA MAY BE REPRODUCED, MODIFIED, TRANSMITTED OR USED IN
ANY FORM OR BY ANY MEANS FOR ANY PURPOSE WITHOUT THE
PRIOR WRITTEN CONSENT OF CPG CONSULTANTS PTD LTD OTHER
THAN THE SOLE PURPOSE FOR WHICH SUCH DRAWINGS, DESIGNS
AND/OR OTHER DATA ARE PROVIDED TO LICENCED USERS ON
SUCH TERMS AS CPG CONSULTANTS PTE LTD MAY PRESCRIBE."

NOTE :
ALL DETAILS SHOWN IN DRAWING ARE INDICATIVE OF ARCHITECT'S
DESIGN INTENT ONLY. CONTRACTOR IS TO CHECK/VERIFY ALL
DIMENSIONS ON SITE & TO SUBMIT SHOP DRAWINGS & FIXING
DETAILS FOR S.O.'S REVIEW & APPROVAL BEFORE COMMENCEMENT
OF ANY FABRICATION WORKS.

SENIOR VICE PRESIDENT (ARCHITECTURE)		MR. CHEONG YEW KEE	
ARCHITECTURE ASSOCIATE (ARCHITECTURE)		MS. VAN ANH HOANG	
PROJECT NO. :	P5541	DRAWN BY :	VAN ANH HOANG
CADD NO. :		CHECKED BY :	CHEONG YEW KEE

JOB TITLE : PARAMOUNT COMMERCIAL MIXED USE DEVELOPMENT @ BATU KAWAN, PENANG, MALAYSIA			
SCALE :	1/1500	REVISION INDEX :	
DATE :	04/06/2015		

DRAWING TITLE : GROUND FLOOR PLAN	
DRAWING NO :	A101