

1,2,3
CARPARK : 675 CP

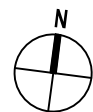

PLOT 01 - CARPARK 1ST,2ND 3RD STOREY FLOOR PLAN

scale 1:600

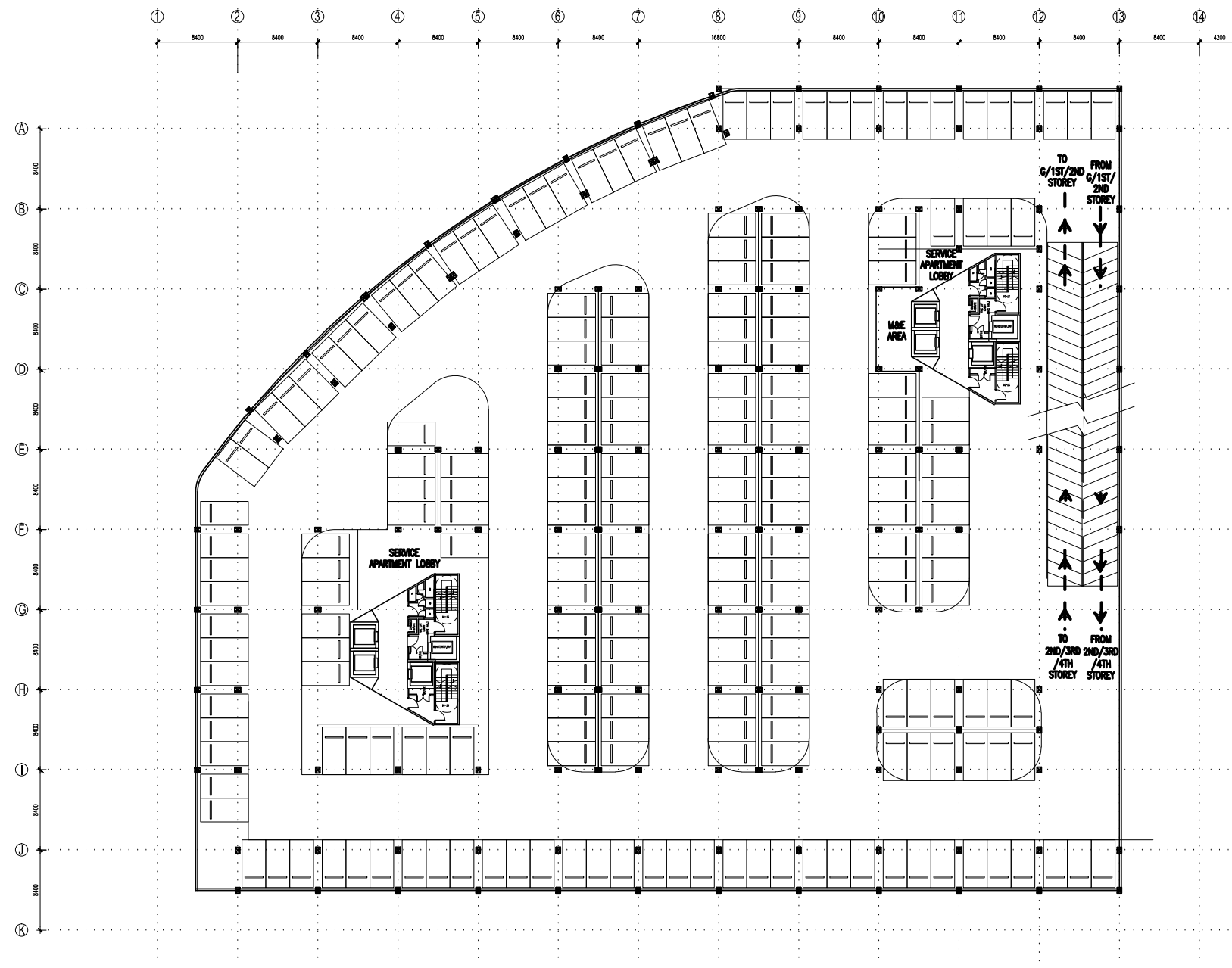

CPG CONSULTANTS PTE LTD

238B, THOMSON ROAD, #12-00 TOWNER B
NOVENA SQUARE, SINGAPORE 307685
TEL : 63574401 FAX : 63574398

" © 2002, CPG CONSULTANTS PTE LTD
CPG CONSULTANTS PTE LTD RESERVES ALL RIGHTS TO THESE
DRAWINGS, DESIGNS AND/OR ANY OTHER DATA CONTAINED
HEREIN. NO PART OF THE DRAWINGS, DESIGNS AND/OR OTHER
DATA MAY BE REPRODUCED, MODIFIED, TRANSMITTED OR USED IN
ANY FORM OR BY ANY MEANS FOR ANY PURPOSE WITHOUT THE
PRIOR WRITTEN CONSENT OF CPG CONSULTANTS PTD LTD OTHER
THAN THE SOLE PURPOSE FOR WHICH SUCH DRAWINGS, DESIGNS
AND/OR OTHER DATA ARE PROVIDED TO LICENCED USERS ON
SUCH TERMS AS CPG CONSULTANTS PTE LTD MAY PRESCRIBE."

NOTE :
ALL DETAILS SHOWN IN DRAWING ARE INDICATIVE OF ARCHITECTS
DESIGN INTENT ONLY. CONTRACTOR IS TO CHECK/VERIFY ALL
DIMENSIONS ON SITE & TO SUBMIT SHOP DRAWINGS & FIXING
DETAILS FOR S.O.'S REVIEW & APPROVAL BEFORE COMMENCEMENT
OF ANY FABRICATION WORKS.

SENIOR VICE PRESIDENT
(ARCHITECTURE)

ARCHITECTURE ASSOCIATE
(ARCHITECTURE)

PROJECT NO. : P5541

CADD NO. :

MS. ADINYA ITTASAQA R

DRAWN BY : ADINYA

CHECKED BY : SOO KHOONG

JOB TITLE :

PARAMOUNT COMMERCIAL
MIXED USE DEVELOPMENT
@ BATU KAWAN, PENANG, MALAYSIA

SCALE :

DATE : 1 : 400

10/07/2015

REVISION INDEX :

DRAWING TITLE :

PLOT 01 - CAR PARK 1ST,2ND,3RD STOREY
FLOOR PLAN

DRAWING NO :

A202