

# 4TH

CARPARK : 183 CP

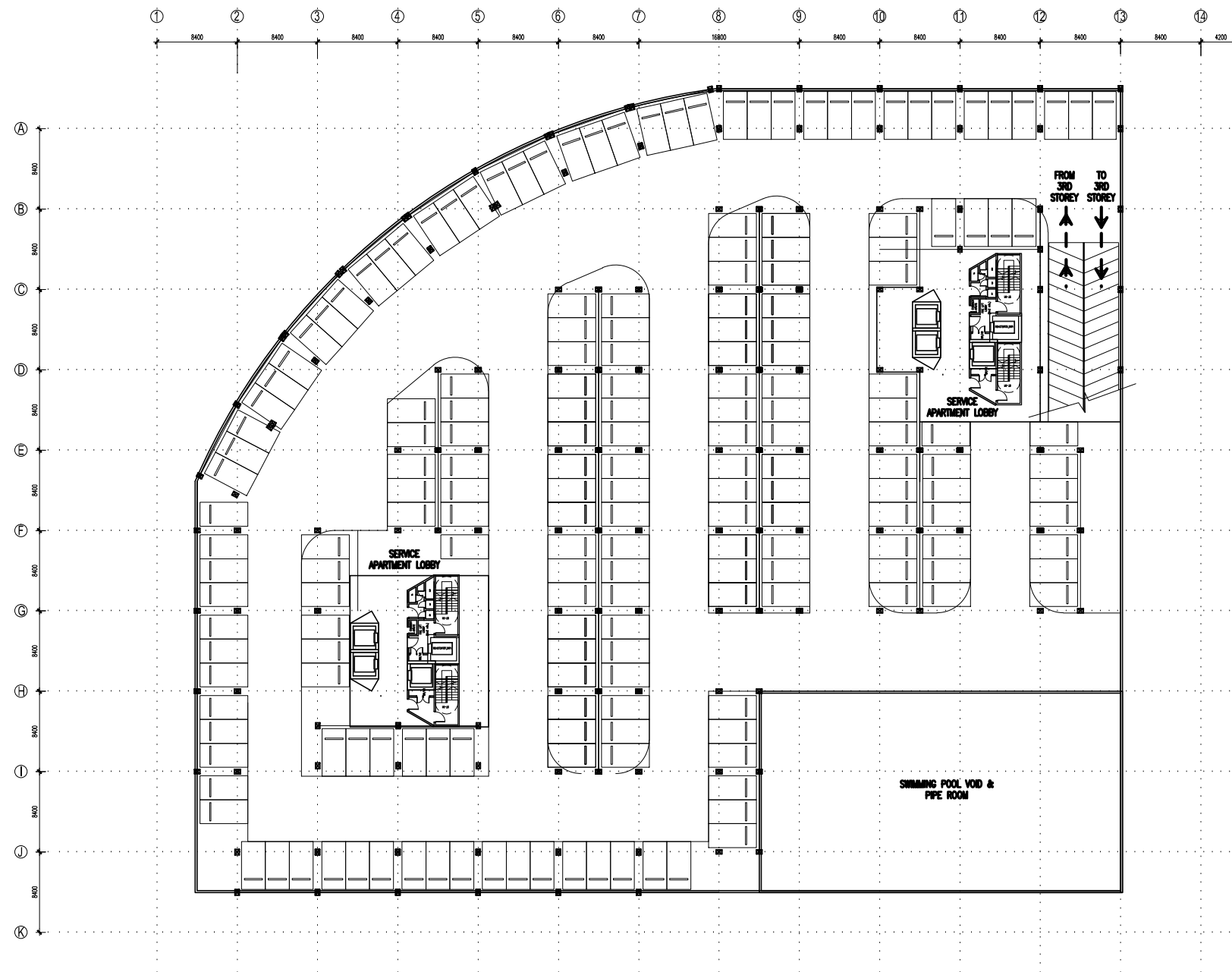

## PLOT 01 - CARPARK 4TH STOREY FLOOR PLAN

scale 1:600



CPG CONSULTANTS PTE LTD

238B, THOMSON ROAD, #12-00 TOWER B  
NOVENA SQUARE, SINGAPORE 307685  
TEL : 63574401 FAX : 63574398

© 2002, CPG CONSULTANTS PTE LTD  
CPG CONSULTANTS PTE LTD RESERVES ALL RIGHTS TO THESE DRAWINGS, DESIGNS AND/OR ANY OTHER DATA CONTAINED HEREIN. NO PART OF THE DRAWINGS, DESIGNS AND/OR OTHER DATA MAY BE REPRODUCED, MODIFIED, TRANSMITTED OR USED IN ANY FORM OR BY ANY MEANS FOR ANY PURPOSE WITHOUT THE PRIOR WRITTEN CONSENT OF CPG CONSULTANTS PTE LTD OTHER THAN THE SOLE PURPOSE FOR WHICH SUCH DRAWINGS, DESIGNS AND/OR OTHER DATA ARE PROVIDED TO LICENCED USERS ON SUCH TERMS AS CPG CONSULTANTS PTE LTD MAY PRESCRIBE.

NOTE : ALL DETAILS SHOWN IN DRAWING ARE INDICATIVE OF ARCHITECTS DESIGN INTENT ONLY. CONTRACTOR IS TO CHECK/VERIFY ALL DIMENSIONS ON SITE & TO SUBMIT SHOP DRAWINGS & FIXING DETAILS FOR S.O.'S REVIEW & APPROVAL BEFORE COMMENCEMENT OF ANY FABRICATION WORKS.

SENIOR VICE PRESIDENT  
( ARCHITECTURE )

ARCHITECTURE ASSOCIATE  
( ARCHITECTURE )

MS. ADINYA ITTASAQA R

PROJECT NO. : P5541

DRAWN BY : ADINYA

CADD NO. :

CHECKED BY : SOO KHOONG

JOB TITLE :  
PARAMOUNT COMMERCIAL  
MIXED USE DEVELOPMENT  
@ BATU KAWAN, PENANG, MALAYSIA

SCALE :  
DATE : 1 : 400 10/07/2015

REVISION INDEX :

DRAWING TITLE :  
PLOT 01 - CAR PARK 4TH STOREY  
FLOOR PLAN

DRAWING NO :  
A203