

HOTEL & STUDIO APARTMENTS MULTI-STOREY CAR PARK - 4TH FLOOR PLAN
scale 1:1000
297 NOS. CAR PARK LOTS

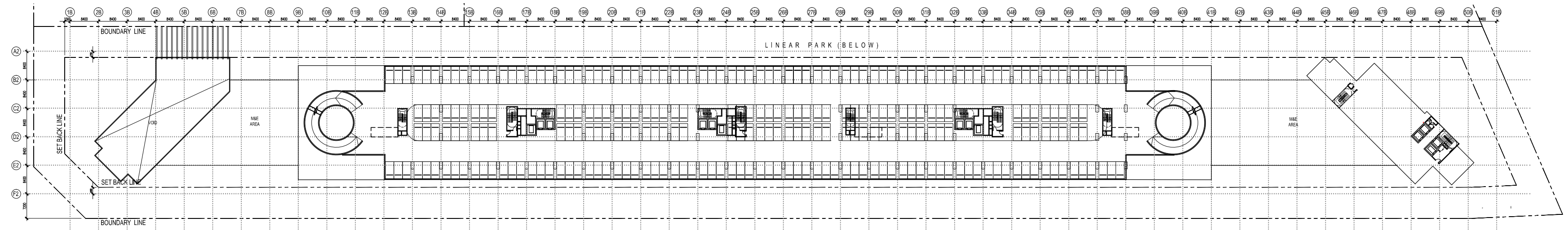

HOTEL & STUDIO APATMENTS MULTI-STOREY CAR PARK - 3RD FLOOR PLAN
scale 1:1000
224 NOS. CAR PARK LOTS

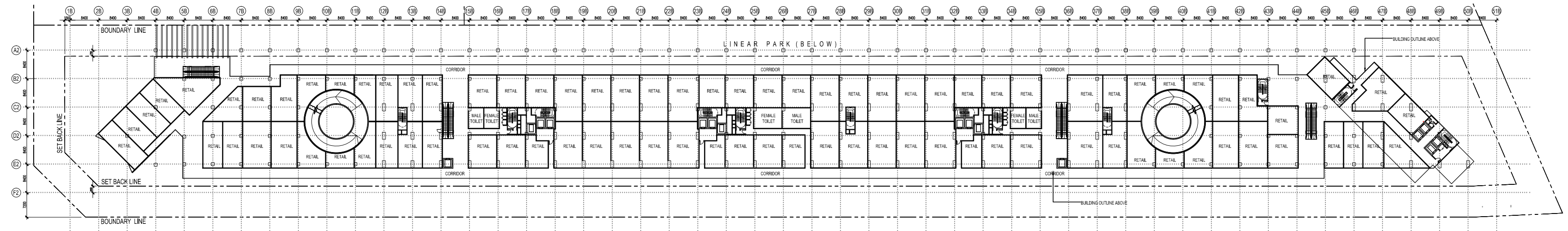

COMMERCIAL RETAIL - 2ND FLOOR PLAN
scale 1:1000



CPG CONSULTANTS PTE LTD

238B, THOMSON ROAD, #12-00 TOWER B
NOVENA SQUARE, SINGAPORE 307685
TEL : 63574401 FAX : 63574398

* © 2002, CPG CONSULTANTS PTE LTD
CPG CONSULTANTS PTE LTD RESERVES ALL RIGHTS TO THESE
DRAWINGS, DESIGNS AND/OR ANY OTHER DATA CONTAINED
HEREIN. NO PART OF THE DRAWINGS, DESIGNS AND/OR OTHER
DATA MAY BE REPRODUCED, MODIFIED, TRANSMITTED OR USED IN
ANY FORM OR BY ANY MEANS FOR ANY PURPOSE WITHOUT THE
PRIOR WRITTEN CONSENT OF CPG CONSULTANTS PTD LTD OTHER
THAN THE SOLE PURPOSE FOR WHICH SUCH DRAWINGS, DESIGNS
AND/OR OTHER DATA ARE PROVIDED TO LICENCED USERS ON
SUCH TERMS AS CPG CONSULTANTS PTE LTD MAY PRESCRIBE.*

NOTE :
ALL DETAILS SHOWN IN DRAWING ARE INDICATIVE OF ARCHITECT'S
DESIGN INTENT ONLY. CONTRACTOR IS TO CHECK/VERIFY ALL
DIMENSIONS ON SITE & TO SUBMITS SHOP DRAWINGS & FIXING
DETAILS FOR S.O.'S REVIEW & APPROVAL BEFORE COMMENCEMENT
OF ANY FABRICATION WORKS.

SENIOR VICE PRESIDENT
(ARCHITECTURE)

ARCHITECTURE ASSOCIATE
(ARCHITECTURE)

PROJECT NO. : P5541

CADD NO. :

MS. VAN ANH HOANG

DRAWN BY :

FARADILLA

CHECKED BY :

JOB TITLE :

PARAMOUNT COMMERCIAL
MIXED USE DEVELOPMENT
@ BATU KAWAN, PENANG, MALAYSIA

SCALE :

1 : 1000

DATE :

06/08/2015

REVISION INDEX :

DRAWING TITLE :

PLOT 2: HOTEL & STUDIO APARTMENTS
COMMERCIAL RETAIL & MULTI-STOREY CAR
PARK - 2ND TO 4TH FLOOR PLANS

DRAWING NO. :

A-251