

# CAR PARK - TYPICAL 1ST, 2ND & 3RD FLOOR PLANS

scale 1:500

CAR PARK LOTS : 660 NOS.

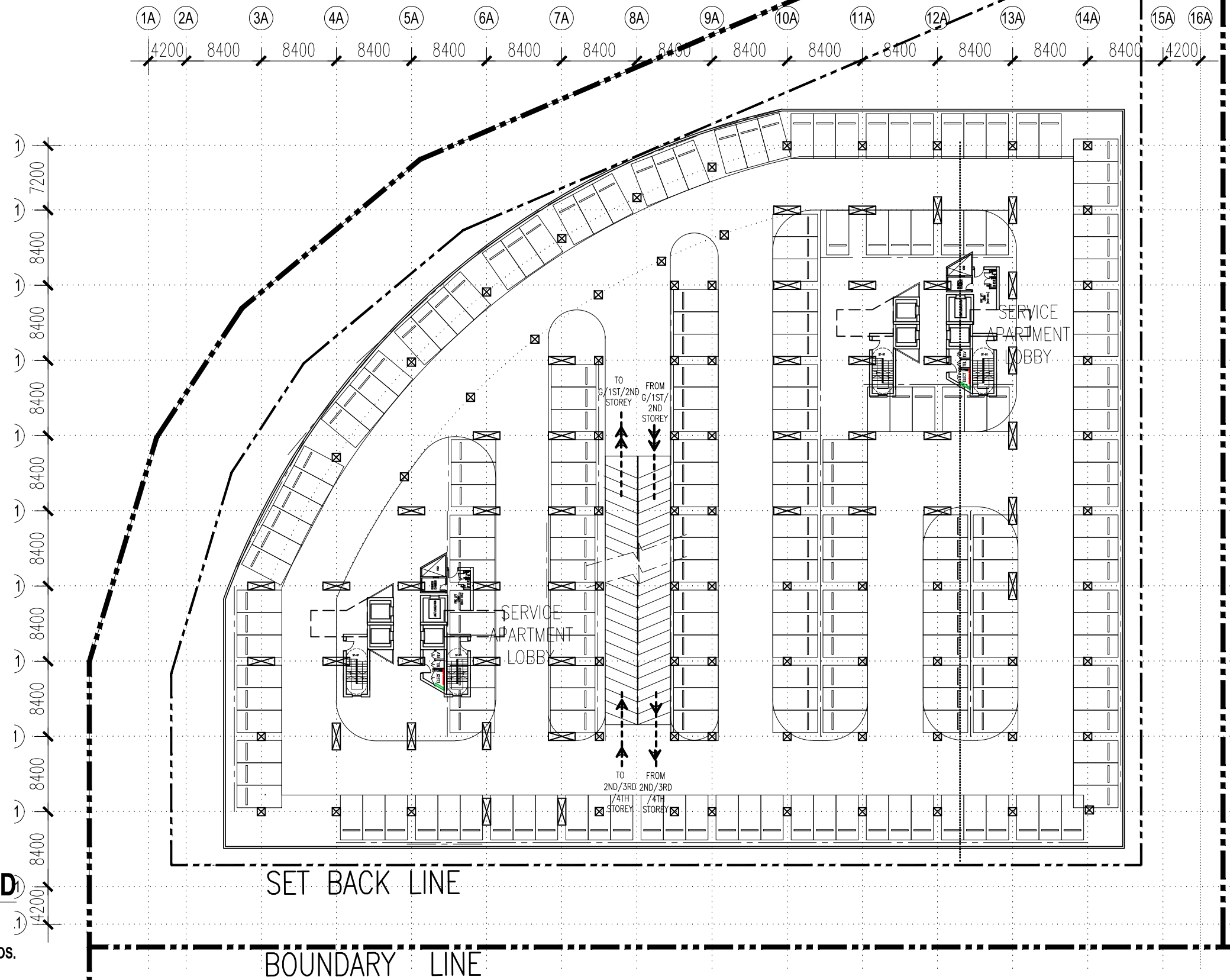

CPG CONSULTANTS PTE LTD  
238B, THOMSON ROAD, #12-00 TOWER B  
NOVENA SQUARE, SINGAPORE 307685  
TEL : 63574401 FAX : 63574398

NOTE :  
ALL DETAILS SHOWN IN DRAWING ARE INDICATIVE OF ARCHITECT'S  
DESIGN INTENT ONLY. CONTRACTOR IS TO CHECK/VERIFY ALL  
DIMENSIONS ON SITE & TO SUBMIT SHOP DRAWINGS & FIXING  
DETAILS FOR S.O.'S REVIEW & APPROVAL BEFORE COMMENCEMENT  
OF ANY FABRICATION WORKS.

SENIOR VICE PRESIDENT  
( ARCHITECTURE )

ARCHITECTURE ASSOCIATE  
( ARCHITECTURE )

PROJECT NO. : P5541

CADD NO. :

MS. ADINYA ITTASAQA R

DRAWN BY : ADINYA

CHECKED BY : SOO KHOONG

JOB TITLE :

PARAMOUNT COMMERCIAL  
MIXED USE DEVELOPMENT  
@ BATU KAWAN, PENANG, MALAYSIA

SCALE : 1:500

DATE : 24/07/2015

REVISION INDEX :

DRAWING TITLE :

PLOT 2: CAR PARK - 1ST, 2ND & 3RD  
FLOOR PLANS

DRAWING NO : A-202